

## DL-101 Installation Manual

The DuraLock DL-100 series is designed to lock trailer doors offering excellent protection against theft. It is bolted to the door without drilling new holes. Simply undo the 2 nuts holding the door hasp and install the DuraLock using the same holes. When engaged, the DuraLock strong pin secures the handle in place.

It unlocks with a key. Designed to meet extreme weather conditions.

### Packaging Content:

1. 1x DuraLock
2. 3x Keys
3. 2x screws 3/8"-24 x 1 1/4" \*
4. 2x screws 3/8"-24 x 3 1/2" \*
5. Installation Manual

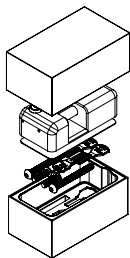

### Tools Needed:

1. Allen Wrench 7/32"
2. Nut wrench 9/16" or 15mm or adjustable wrench



### Notes:

- The 1 1/4" long screws supplied with the DuraLock are suitable for the standard 1/2" thick trailer doors.
- Doors that are thicker than 1/2", require mounting screws that are equal to the thickness of the door plus 1/2".
- 2x 3 1/2" screws provided for 3" thick doors such as reefer.
- The screws are 3/8" - 24 x L" (L = the required length).



Scan this QR code for detailed Installation Manual



8 60011 01550 5

T5TEK Inc.  
16731 Trudy Lane  
Huntington Beach,  
CA 92647  
United States

www.t5tek.com  
sales@t5tek.com  
+1 (714) 398-3115



## DL-101 Installation Manual

1

**Remove the HASP from the trailer door**

- Undo the 2 screws and nuts holding the HASP to the Door

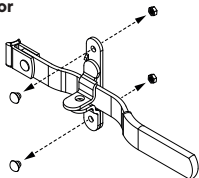

2

**Adjust the spacing of the floating socket to match the holes on the door.**

- Measure the hole spacing on the trailer door
- Adjust the floating socket on the DuraLock to match the spacing on the door

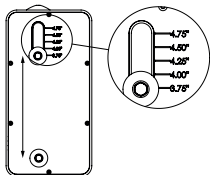

3

**Install the DuraLock**

- Insert the two 3/8\"-24 x 1 1/4\" screws into the holes of the door
- Line up the bottom screw on the door with the bottom hole of the DuraLock and turn the screw until it is engaged. Do not tighten the screw.
- Line up the top screw of the door with the top hole of the DuraLock and turn the screw until it is engaged
- Tighten both screws

